



charming family home

culver city, ca

310.915.9000

3816 Main St, Culver City

residential & commercial

welcome@playarealtyca.com

playa realty

CA DRE# 01251369

charming family home property overview

5204 Selmaraine Dr, Culver City, CA 90230



3/2
bed/bath

±1,432 SF
building SF

±5,000 SF
lot SF

\$4,500/mo
price

a rare find in culver city

A recently renovated hidden gem offers much to be desired with new hardwood floors, a modern and spacious kitchen, and a sizable backyard. Located in the Sunkist Park neighborhood of South Culver City, this home borders Playa Vista and Del Rey and has plenty of dining, shopping, and entertainment options nearby. Within walking distance is the El Marino Elementary School, a National Blue Ribbon School, known for their language immersion programs in Spanish and Japanese.

310.915.9000

3816 Main St, Culver City

residential & commercial

welcome@playarealtyca.com

playa realty

CA DRE# 01251369

charming family home area overview

5204 Selmaraine Dr, Culver City, CA 90230



39,432
population

16,500
households





\$86,997
median income

41
median age

driving distances from property

nearby cities	
Playa Vista	±2.1mi
Westchester	±2.5mi
Playa Del Rey	±4.1mi
Marina Del Rey	±4.6mi
Venice	±4.8mi
Santa Monica	±6.6mi
Brentwood	±6.7mi
Century City	±6.8mi
Westwood	±7.0mi
Beverly Hills	±8.5mi
Hollywood	±10.2mi
Downtown Los Angeles	±11.9mi

local points of interest	
Westfield Culver City	±0.7mi
Braddock Drive Elementary	±0.8mi
Trader Joe's	±0.9mi
Central Park	±1.1mi
Google Spruce Goose	±1.4mi
Facebook LA	±1.8mi
Culver City High School	±1.8mi
Culver City Middle School	±1.9mi
Sony Pictures Studios	±2.6mi
Culver Studios	±3.4mi
UCLA	±7.1mi
University of Southern California	±8.3mi

 ±1.3mi	 ±1.2mi	 ±2.8mi	 ±4.8mi	 ±0.7mi
---	---	---	---	---

culver city

Culver City is world renowned for its rich history in the entertainment industry. Home to MGM studios during the Hollywood Golden Era, it is now home to Sony Picture Studios, Amazon Studios, and HBO. Headquartered in Culver City are companies such as Beats Electronics, NFL Media, and Sony Pictures Entertainment.

Culver City is a sovereign city within Los Angeles County and has its own city council and school district. The Culver City Fire Department is one of 56 fire departments in the United States to have an ISO class 1 rating and achieve accreditation from the CFAI. The Culver City Unified School District serves approximately 6,500 students, compared to the LAUSD's 734,000 students.



the culver hotel

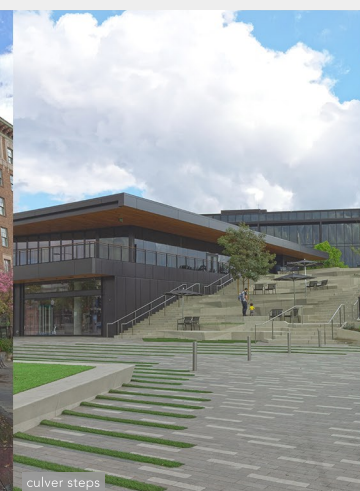

culver steps



culver city sign

Culver City Sign image courtesy of Wikipedia

310.915.9000

3816 Main St, Culver City

residential & commercial

welcome@playarealtyca.com

playa realty

CA DRE# 01251369

5204 Selmaraine Dr, Culver City, CA 90230



about us

playa realty is a boutique firm located in the heart of Culver City, assisting clients with both **residential** and **commercial** real estate needs. Services include **sales**, **leasing**, and **management**. With a team led by **Monica Trepany** and her years of expertise, the firm delivers the highest quality service in the industry.

list with us.



playarealtyca.com/list

other playa listings

